

RAK-MOON
Close Coupled | Water Closet

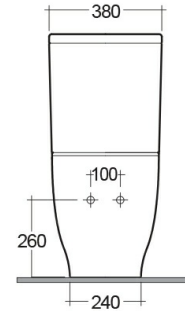

RAK
CERAMICS

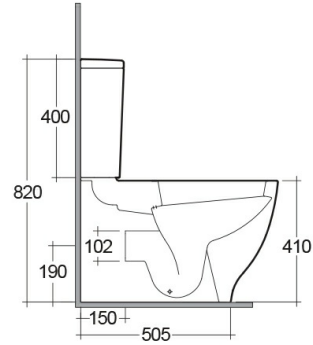
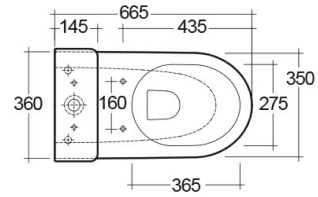

Technical specifications

Dimensions:	665 x 360 mm
Weight:	49 Kg
Color:	Alpine White
Trap type:	P Trap & S Trap
Trapway type:	Concealed
Seat cover options:	Urea
Bowl shape:	Oval
Soft close:	yes
Dual flush:	yes
Suites:	

Code	Name
HAR16AWHA	MOON WATER CLOSET CLOSE COUPLED P S-TRAP 66CM
HAR10AWHA	MOON WATER CLOSET TANK

Dimensions: All dimensions in mm tolerance $\pm 5\%$ for below 200mm and $\pm 3\%$ for above 200mm.
 Note: Due to a continuing development programme to improve design and performance, the manufacturer reserves all rights to vary specifications without prior information.
 Please note accessories are for photographic use only.